

# Bertha Park Bulletin Issue 1

Welcome to the first edition of the Bertha Park Bulletin



This will be a regular newsletter to give you information about our move to Bertha Park



You will have received a letter from our Chief Executive Brian Logan to tell you about this move.



We want to involve you in the design process and keep you informed as often as we can on new developments.



We can also announce that an exhibition space has been created at Upper Springland where you can come and view it.



## Why do we have to move?

The quality of care at Upper Springlands is amazing but the buildings are now 40 years old and are difficult and expensive to maintain.

There is also a risk of flooding from the River Tay.

## Why Bertha Park?

Our aim is to deliver the best new models of housing and care in the UK.

It's the biggest project Capability Scotland have taken on.

It's also just 4 miles away so we can keep our strong links within the local neighbourhood.



## What role can you play?

To help us with this task we are committed to involve all those with clear interests to play a part in the design and eventual move.

Although its at an early stage we want to reassure you your voice and opinions will be heard.

We also want anyone with a concern or issue to let us know.



## When will this happen?

Nothing will change immediately with your care and service. Any move is likely to be in 2025.

The board still has to discuss and make a formal planning application.



# A look into the Future



Site Location

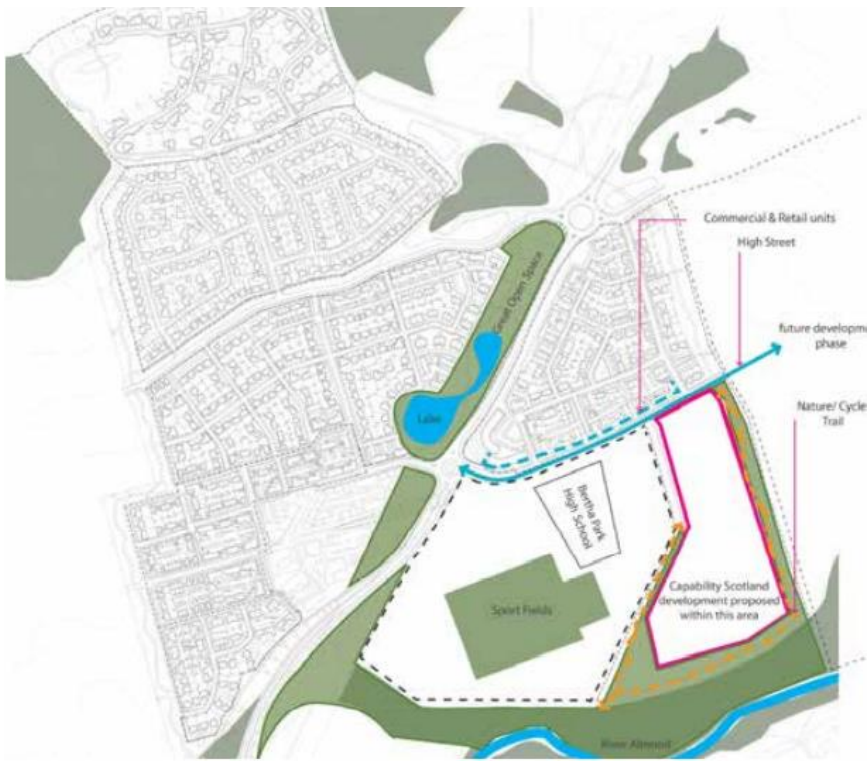

Masterplan



The High Street



Open space and Lake



Bertha Park High School

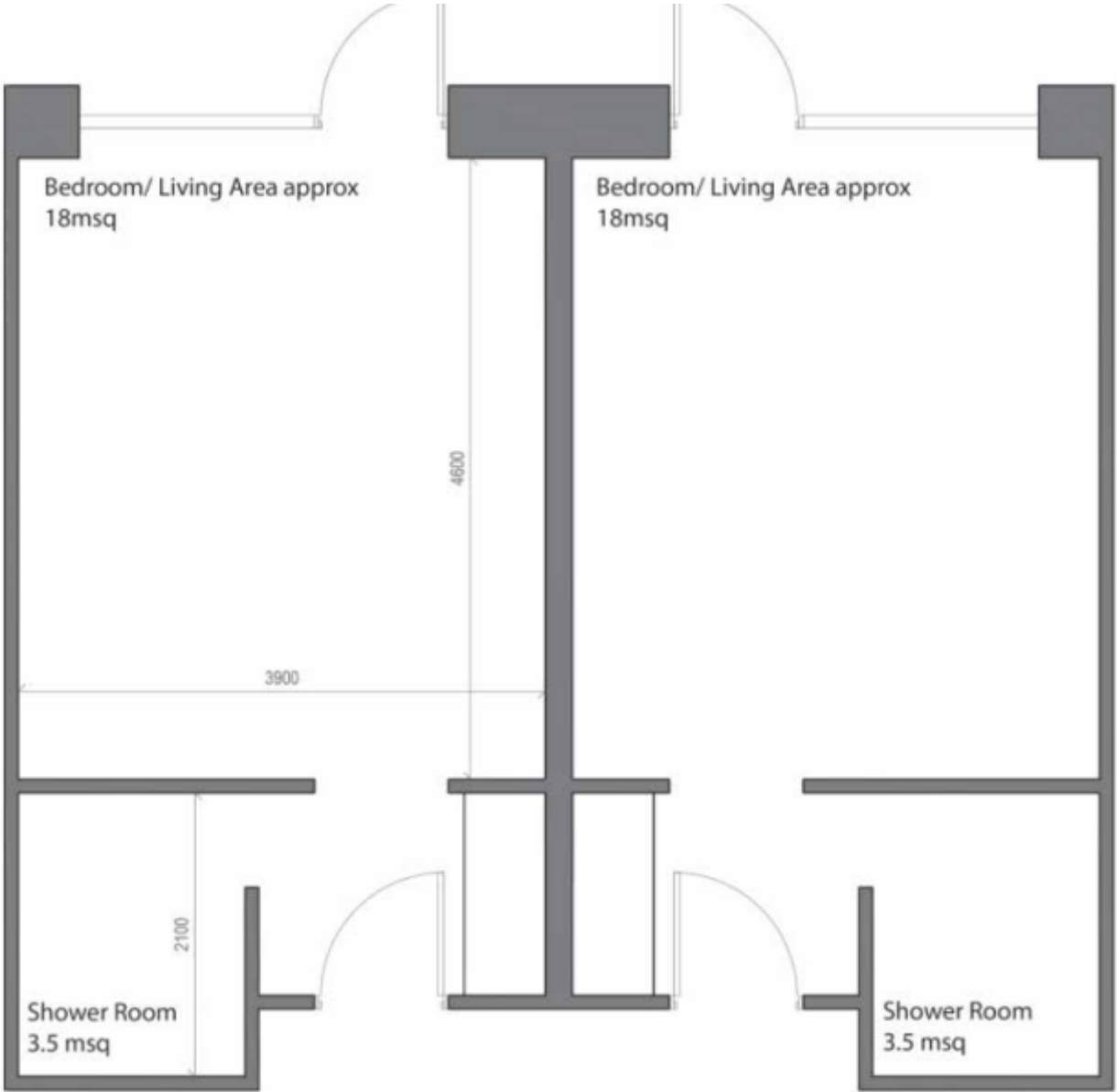

Existing Bedroom Plan



Proposed Layout Plan

Example Bedroom



Example Ensuite bathroom



# Have Your Say



The Bertha Park Project will be the biggest project Capability Scotland has ever undertaken.



That's why we want to involve our customers, families/relatives and staff in every aspect of the planning and design.



This is your chance to say what you value most at Upper Springland, what are the best aspects of it we should protect and what can we do better to help our customers live their best life?



There is a comments box and places to record your opinions on the new information board at Upper Springland.

Please speak to us.

# Why can't we redevelop Upper Springland?



There are complex planning requirements



It would cause incredible disruption



There would still be a risk of flooding



It would be very costly

**You say Bertha Park will be exemplar – What does that mean?**



A new development at Bertha Park will include sector leading building design and construction. To the model of care delivered.



We will be ambitious and aspirational for our customer's ,



The proposed development will be in the heart of the community with close links to schools, shops, libraries, gyms, GP Surgeries and nurseries and of course other residents.

# How Long will it take for the new service to be up and running?



We don't think we will be able to move until 2025 at the earliest.



We need to:

Making sure that, what people want we can deliver



Getting planning permission



Having the money we need in place

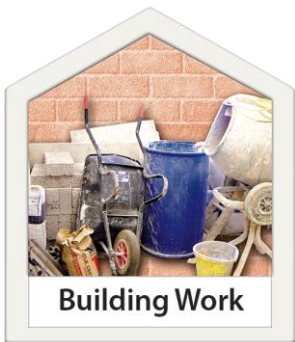

Undertaking the build

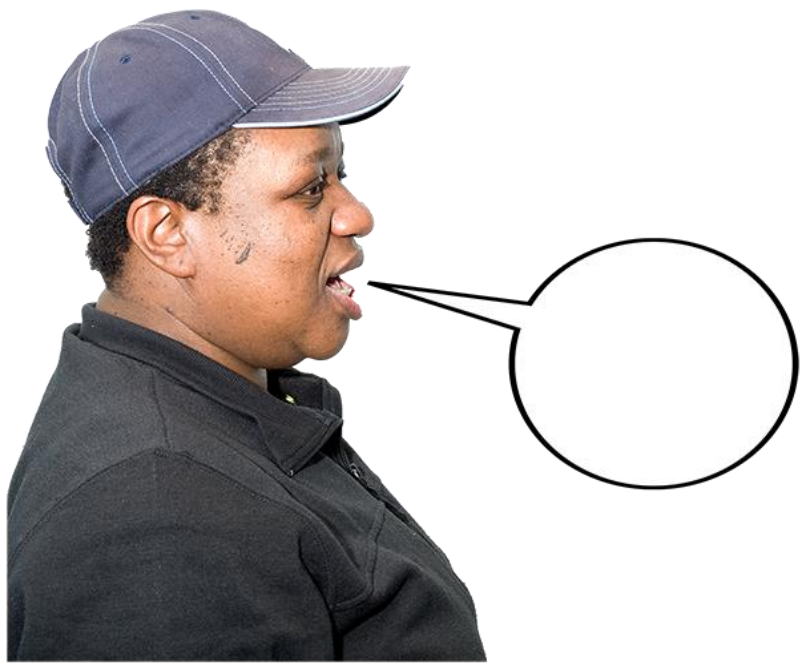

If you have anything you'd want to tell us, please speak to one of the Management team at Upper Springland

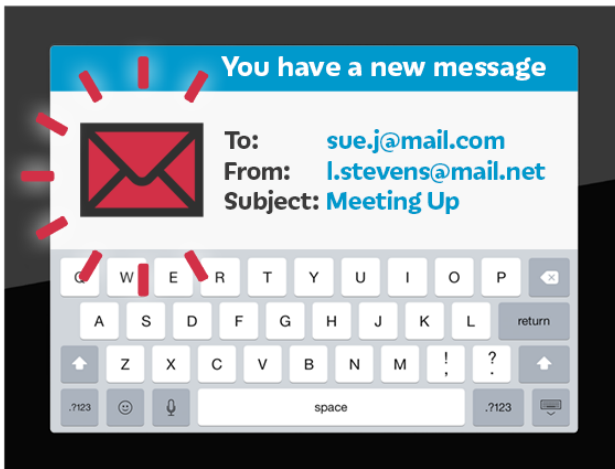

Send a message to

[UpperSpringland@capability.scot](mailto:UpperSpringland@capability.scot)